

Pump

12V DC 15L/min

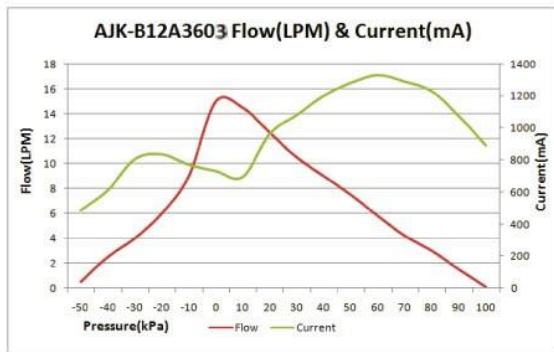
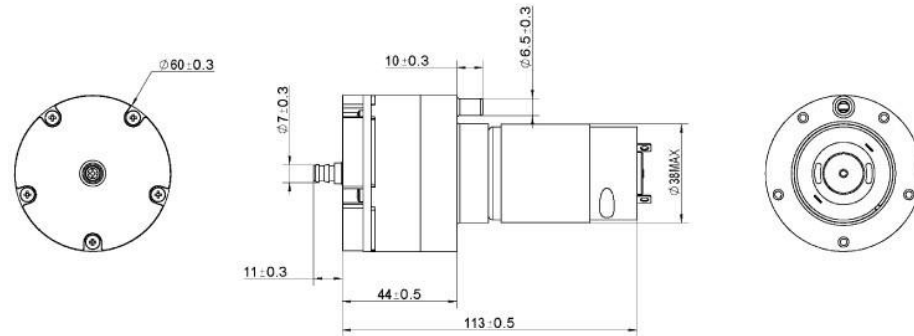

Product Specification

Rated Voltage	Rated Current	Free Flow	Pressure	Noise	Load
DC 12.0 V	< 1500 mA	> 13.0 LPM	-50~80 KPa	< 65 dB	Air & Vacuum
DC 24.0 V	< 800 mA	> 13.0 LPM	-50~80 KPa	< 65 dB	Air & Vacuum